

TACT Switch™ Radial Type

9.0mm Diameter (Radial) SKRC Series

Round terminal design with excellent mountability, achieving water-proof and dust-proof performance.



Water-proof Type



Dust-proof Type

- Series type: Sharp feeling type
- Rating (max.): 50mA 12V DC
- Rating (min.): 10 μ A 1V DC

Applications:Energy_Industrial:Industrial equipment
Home:Major home appliances

■ Product List

Products No.	Operating direction	Operating force (N)	Travel (mm)	Operating life (cycles)	Initial contact resistance	Dimensions (W×D×H) (mm)	Water-proof	Dust-proof	Water-proof & Dust-proof	Automotive	Drawing No.
SKRCACD010	Top push	1.57	0.25	100,000	500mΩ max.	φ9mm×13	●	●	In the coated state	—	1
SKRCADD010	Top push	2.55	0.25	100,000	500mΩ max.	φ9mm×13	●	●	In the coated state	—	



1. This catalog shows only outline specifications. When using the products, please obtain formal specifications for supply.
2. When the switch is used in an environment subject to high humidity or condensation, make sure the terminals are coated thoroughly to prevent current leakage between terminals.
3. Avoid using coating material coating toluene or xylene. For more information on coating material, please contact us.
4. Switch terminals must be coated thoroughly until the terminals are fully covered.
5. For more information on coating material, please contact us.
6. Please use 1.6mm thick PC boards.
7. Please place purchase orders for taping products per minimum order unit (1 box or a case).

■ Packing Specifications

Radial taping

Number of packages(pcs.)			Export package measurements (mm)
1 box	1 case / Japan	1 case / export packing	
900	9,000	9,000	353×764×309

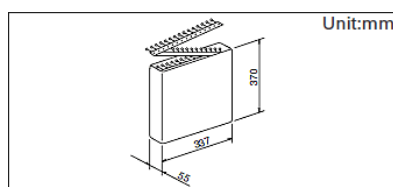

Drawing No.1

■ Dimensions

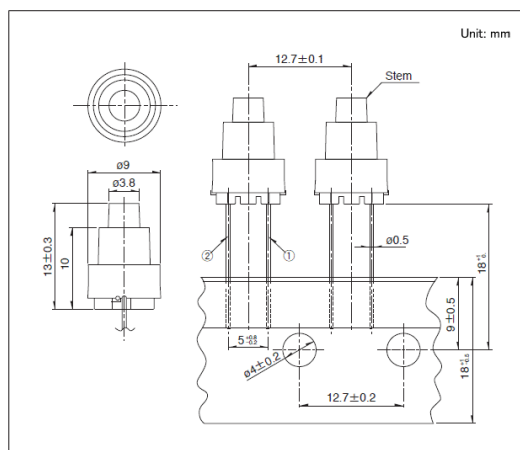

■ Mounting Hole Dimensions

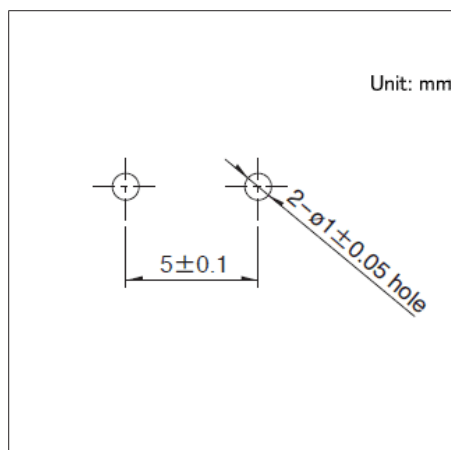

Viewed from mounting face.

- Circuit Diagram

