

TACT Switch™ Snap-in Type

6.6mm Square (Snap-in)

SKQJ Series

Simple dust-proof type with sharp operation feel and excellent versatility.



 Dust-proof Type

- Series type: Sharp feeling type
- Rating (max.): 50mA 12V DC
- Rating (min.): 10μA 1V DC

Applications: Energy_Industrial: Industrial equipment
 Healthcare: Healthcare equipment, Analysis, test equipment
 Home: Major home appliances, Office equipment
 Audio_TV: Visual, Audio, Pro audio

■ Product List

Products No.	Type	Operating direction	Operating force (N)	Travel (mm)	Operating life (cycles)	Initial contact resistance	Dimensions (W×D×H) (mm)	Water-proof	Dust-proof	Automotive	Drawing No.
SKQJAAA010	Top push type	Top push	0.98	0.25	1,000,000	100mΩ max.	6.6×6.6×5.0	—	●	—	1
SKQJABA010		Top push	1.57	0.25	500,000	100mΩ max.	6.6×6.6×5.0	—	●	—	
SKQJADA010		Top push	0.98	0.25	1,000,000	100mΩ max.	6.6×6.6×7.0	—	●	—	2
SKQJAEA010		Top push	1.57	0.25	500,000	100mΩ max.	6.6×6.6×7.0	—	●	—	
SKQJAJA010		Top push	0.98	0.25	200,000	100mΩ max.	6.6×6.6×9.5	—	●	—	3
SKQJAKA010		Top push	1.57	0.25	200,000	100mΩ max.	6.6×6.6×9.5	—	●	—	
SKQJLAA010	Side push type	Side push	0.98	0.25	1,000,000	100mΩ max.	7.5×7.85×7.0	—	●	—	4
SKQJLBA010		Side push	1.57	0.25	500,000	100mΩ max.	7.5×7.85×7.0	—	●	—	

Note

1. This catalog shows only outline specifications. When using the products, please obtain formal specifications for supply.
2. Please use 1.6mm thick PC boards.
3. Please place purchase orders per minimum order unit (integer).

■ Packing Specifications

Bulk

Number of packages(pcs.)		Export package measurements (mm)
1 case / Japan	1 case / export packing	
10,000	30,000	309 x 476 x 347

TACT Switch™ Snap-in Type

6.6mm Square (Snap-in)
SKQJ Series

Drawing No.1

■ Dimensions

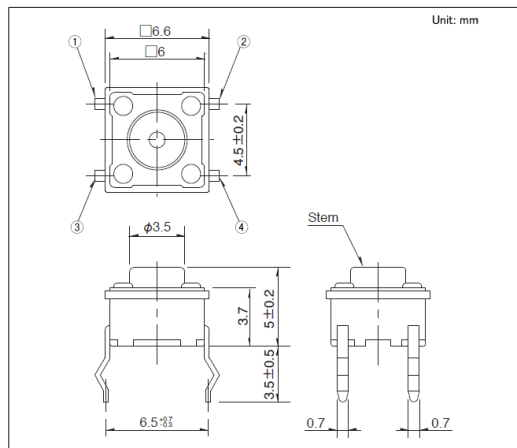

■ Mounting Hole Dimensions

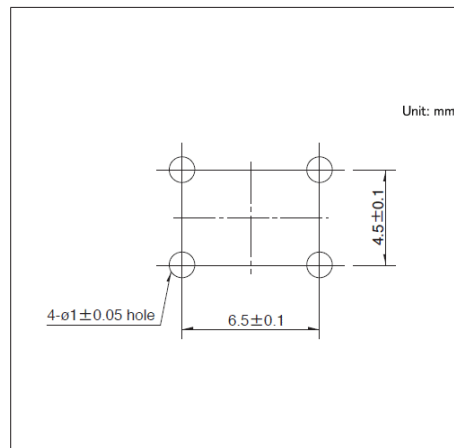

■ Circuit Diagram

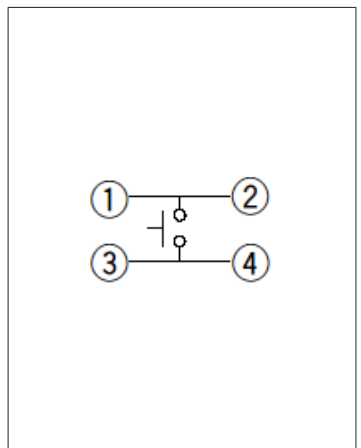

Viewed from mounting face.

Drawing No.2

■ Dimensions

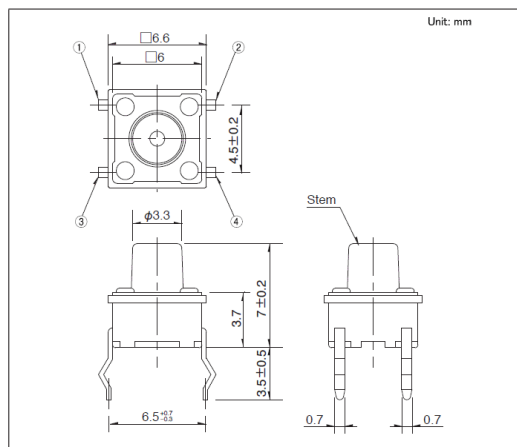

■ Mounting Hole Dimensions

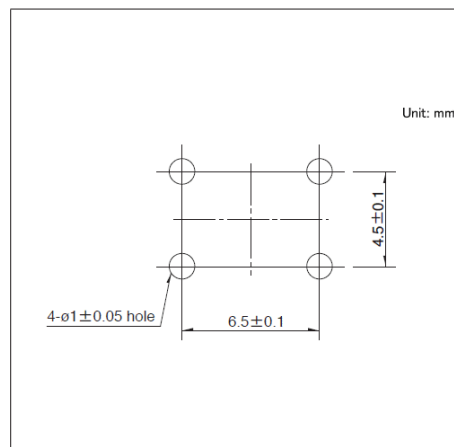

■ Circuit Diagram

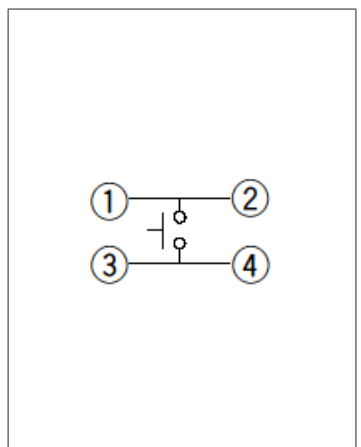

Viewed from mounting face.

Drawing No.3

■ Dimensions

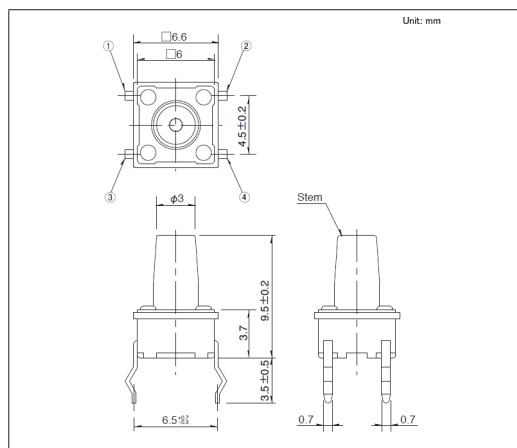

■ Mounting Hole Dimensions

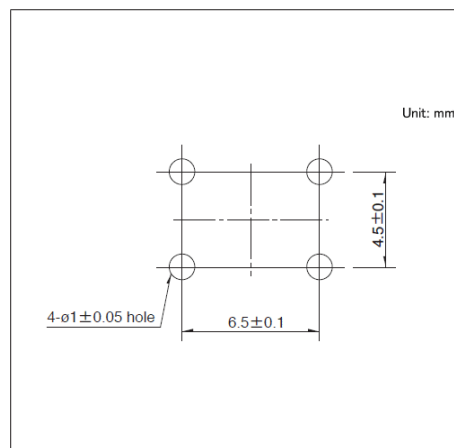

■ Circuit Diagram

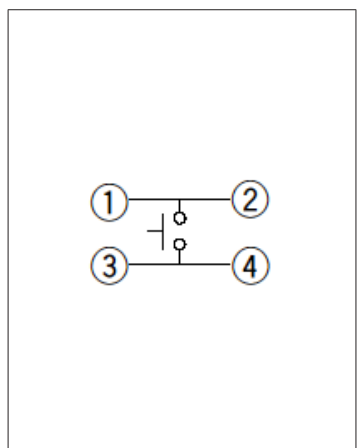

Viewed from mounting face.

TACT Switch™ Snap-in Type

6.6mm Square (Snap-in)
SKQJ Series

Drawing No.4

■ Dimensions

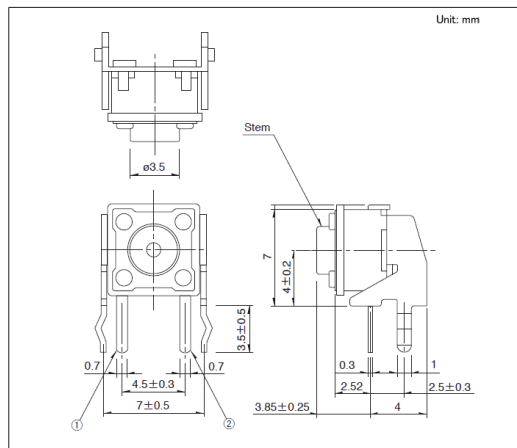

■ Mounting Hole Dimensions

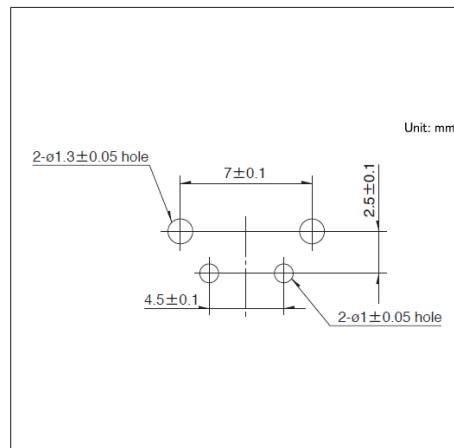

■ Circuit Diagram

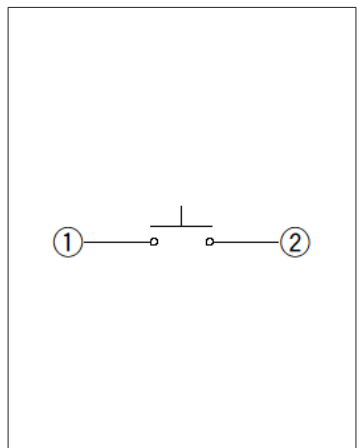

Viewed from mounting face.