

## Switches

## Rotary Switches

## 6-positions Horizontal Type

**SRBM Series**

Same shape available as a pulse switch (20 pulses).



- Rating (max.)/(min.) (Resistive load): 0.1 A 16 V DC/50  $\mu$ A 3 V DC
- Contact resistance (Initial performance/After lifetime):  
50 m $\Omega$  max./150 m $\Omega$  max.
- Operating life without load: 10,000 cycles 100 m $\Omega$  max.
- Operating life with load (at max. rated load): 10,000 cycles 150 m $\Omega$  max.

Applications: Energy\_Industrial: Industrial equipment

## ■ Product List

Products No.	Poles	Positions	Changeover angle	Changeover timing	Rotational torque	Actuator configuration	Actuator length	Dimensions (W×D×H) (mm)	Automotive	Drawing No.
SRBM120700	2	2	30±3°	Non shorting	40±20mN·m	18-tooth serration	L: 15mm	10.0×12.5×11.5	—	1
SRBM121300	2	2	30±3°	Non shorting	40±20mN·m	Flat	L: 15mm	10.0×12.5×11.5	—	2
SRBM131300	2	3	30±3°	Non shorting	40±20mN·m	18-tooth serration	L: 15mm	10.0×12.5×11.5	—	3
SRBM131400	2	3	30±3°	Non shorting	40±20mN·m	18-tooth serration	L: 20mm	10.0×12.5×11.5	—	
SRBM140700	2	4	30±3°	Non shorting	40±20mN·m	18-tooth serration	L: 15mm	10.0×12.5×11.5	—	4
SRBM140800	2	4	30±3°	Non shorting	40±20mN·m	18-tooth serration	L: 20mm	10.0×12.5×11.5	—	
SRBM149501	2	4	30±3°	Non shorting	40±20mN·m	Flat	L: 20mm	10.0×12.5×11.5	—	5
SRBM150500	1	5	30±3°	Non shorting	40±20mN·m	18-tooth serration	L: 15mm	10.0×12.5×11.5	—	6
SRBM154002	1	5	30±3°	Non shorting	40±20mN·m	Flat	L: 15mm	10.0×12.5×11.5	—	7
SRBM160700	1	6	30±3°	Non shorting	40±20mN·m	18-tooth serration	L: 15mm	10.0×12.5×11.5	—	8
SRBM1L0800	1	20-pulses	18±3°	—	15±7mN·m	18-tooth serration	L: 15mm	10.0×12.9×11.5	—	9
SRBM1L1400	1	20-pulses	18±3°	—	15±7mN·m	Flat	L: 15mm	10.0×12.9×11.5	—	10

## ⚠ Note

1. This catalog shows only outline specifications. When using the products, please obtain formal specifications for supply.
2. All the axis are die casting shafts.
3. Please place purchase orders per minimum order unit (integer).

## ■ Packing Specifications

## Tray

Products No.	Number of packages(pcs.)		Export package measurements (mm)
	1 case / Japan	1 case / export packing	
SRBM120700 SRBM121300 SRBM131300 SRBM140700 SRBM150500 SRBM154002 SRBM160700 SRBM1L0800 SRBM1L1400	360	1,800	400 x 270 x 290
SRBM131400 SRBM140800 SRBM149501	210	1,050	400 x 270 x 290

## Switches Rotary Switches

6-positions Horizontal Type  
SRBM Series

## Drawing No.1

## ■ Dimensions

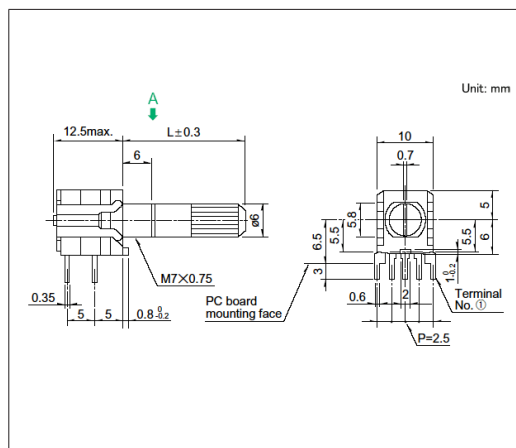

## ■ Mounting Hole Dimensions

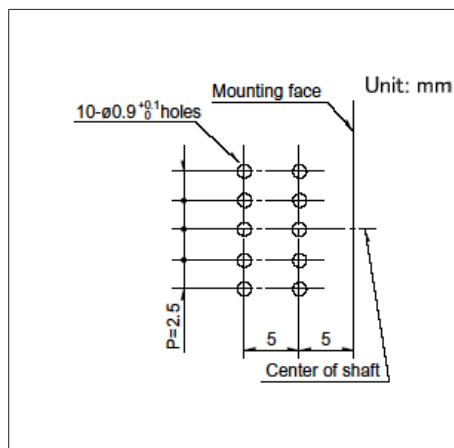

Viewed from direction A in the dimensions.

## ■ Circuit Diagram and Dummy Terminals

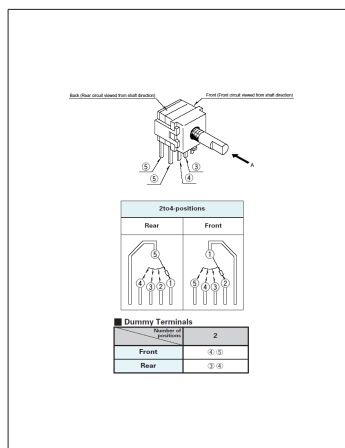

1. Viewed from direction A.  
2. For positions 2, 1 section consists of 2-poles.

## Drawing No.2

## ■ Dimensions

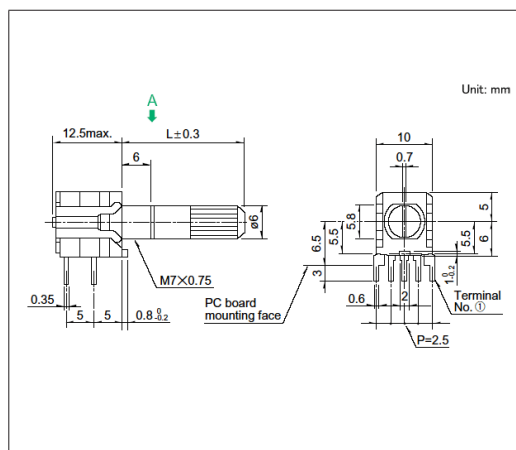

## ■ Mounting Hole Dimensions

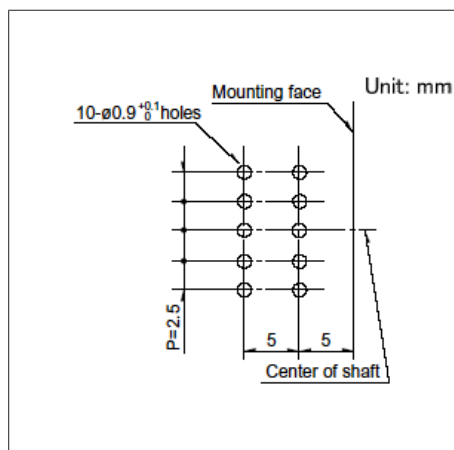

Viewed from direction A in the dimensions.

## ■ Circuit Diagram and Dummy Terminals

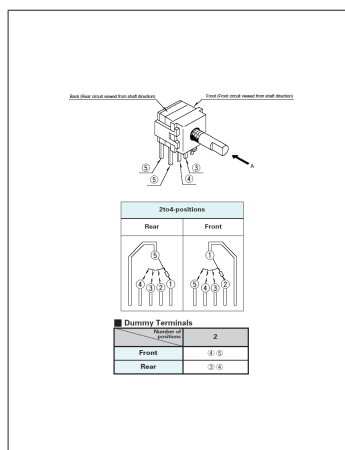

1. Viewed from direction A.  
2. For positions 2, 1 section consists of 2-poles.

## Drawing No.3

## ■ Dimensions

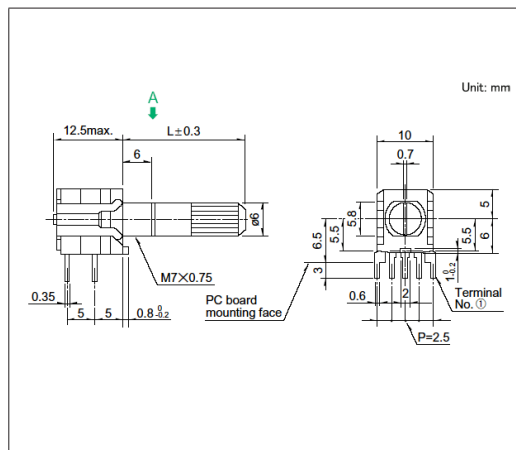

## ■ Mounting Hole Dimensions

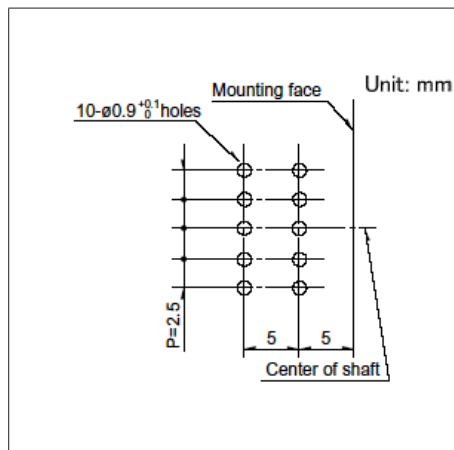

Viewed from direction A in the dimensions.

## ■ Circuit Diagram and Dummy Terminals

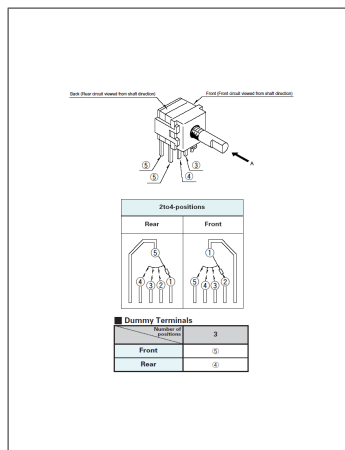

1. Viewed from direction A.  
2. For positions 3, 1 section consists of 2-poles.

## Switches Rotary Switches

6-positions Horizontal Type  
SRBM Series

## Drawing No.4

## ■ Dimensions

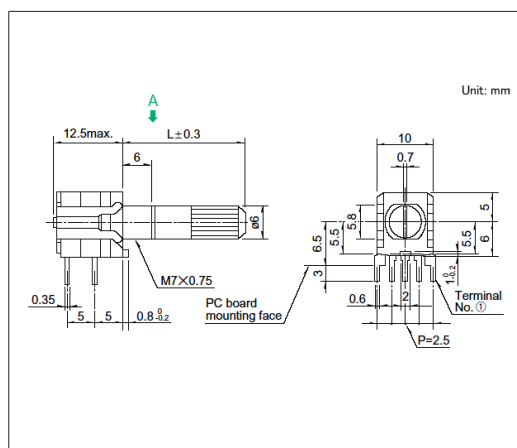

## ■ Mounting Hole Dimensions

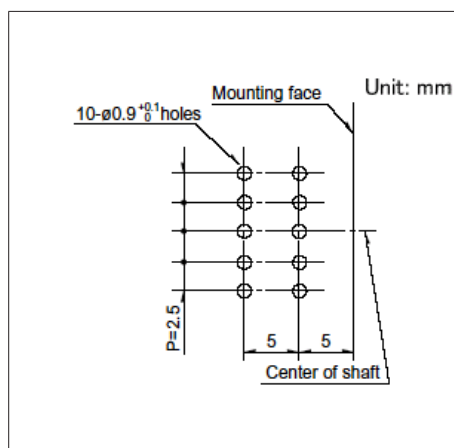

Viewed from direction A in the dimensions.

## ■ Circuit Diagram

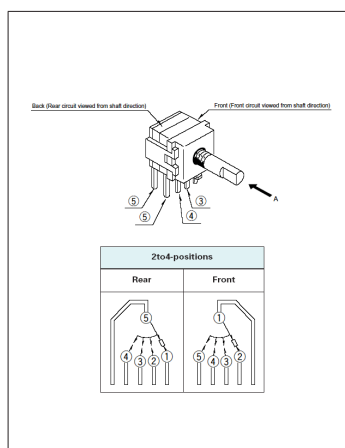

1. Viewed from direction A.
2. For positions 4, 1 section consists of 2-poles.

## Drawing No.5

## ■ Dimensions

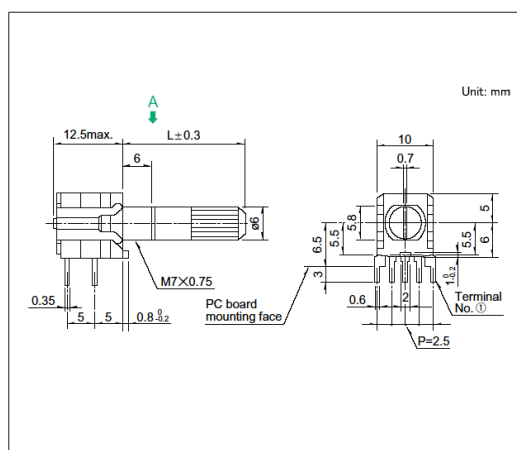

## ■ Mounting Hole Dimensions

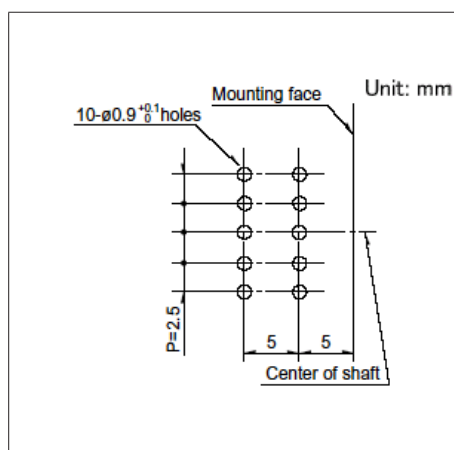

Viewed from direction A in the dimensions.

## ■ Circuit Diagram

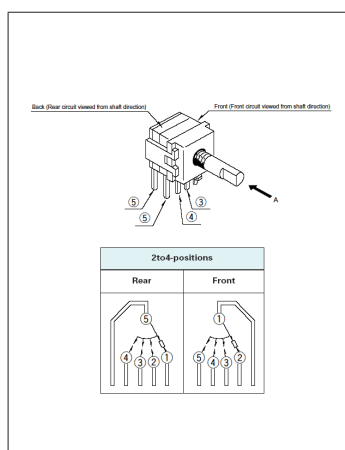

1. Viewed from direction A.
2. For positions 4, 1 section consists of 2-poles.

## Drawing No.6

## ■ Dimensions

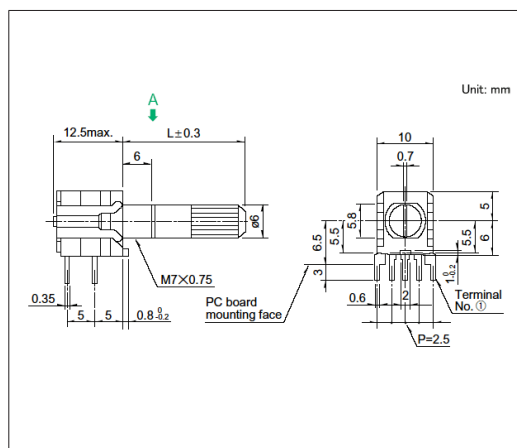

## ■ Mounting Hole Dimensions

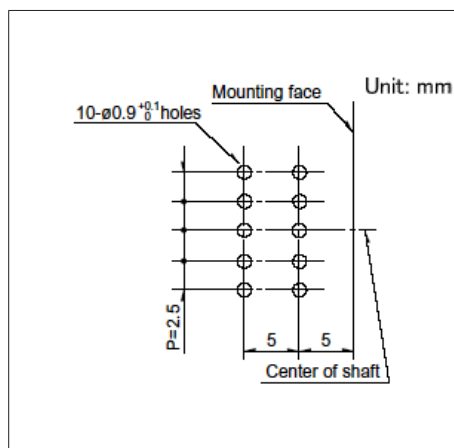

Viewed from direction A in the dimensions.

## ■ Circuit Diagram

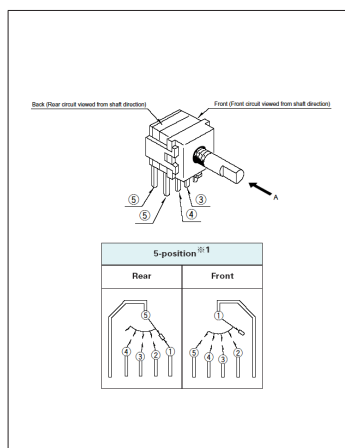

1. Viewed from direction A.
2. Circuit steps are 2 to 5 positions at front and 1 to 4 positions at rear.
3. It is necessary external wiring of common terminals.
4. For positions 5, 1 section consists of 1-pole.

## 6-positions Horizontal Type SRBM Series

## Drawing No.7

## ■ Dimensions

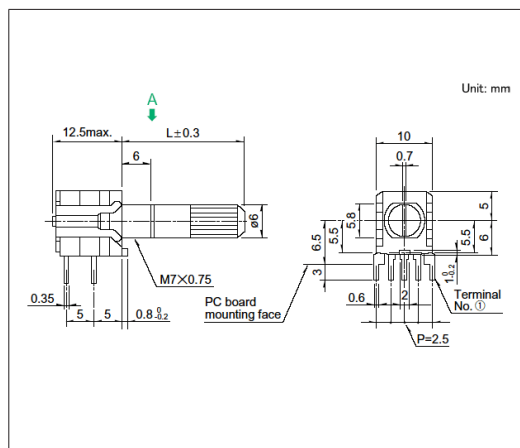

### ■ Mounting Hole Dimensions

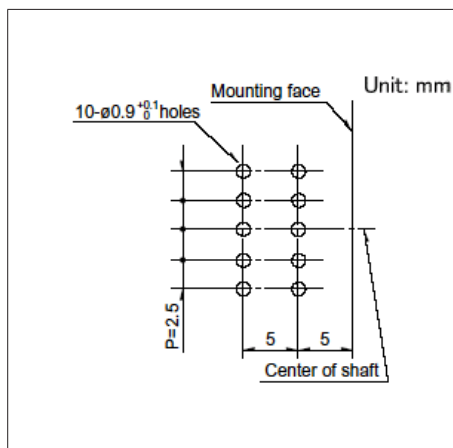

Viewed from direction A in the dimensions.

- Circuit Diagram

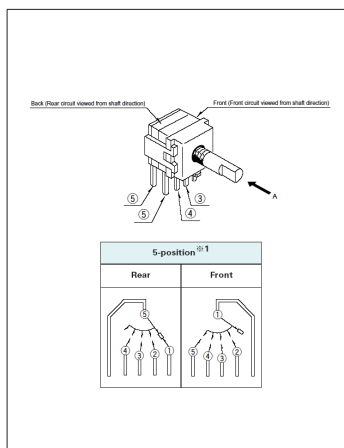

1. Viewed from direction A.
2. Circuit steps are 2 to 5 positions at front and 1 to 4 positions at rear.
3. It is necessary external wiring of common terminals.
4. For positions 5, 1 section consists of 1-pole.

## Drawing No.8

## ■ Dimensions

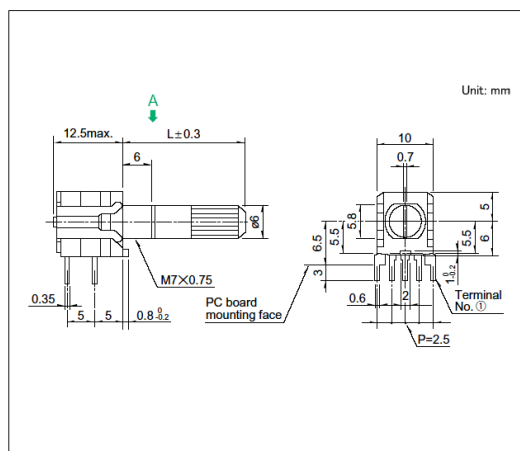

### ■ Mounting Hole Dimensions

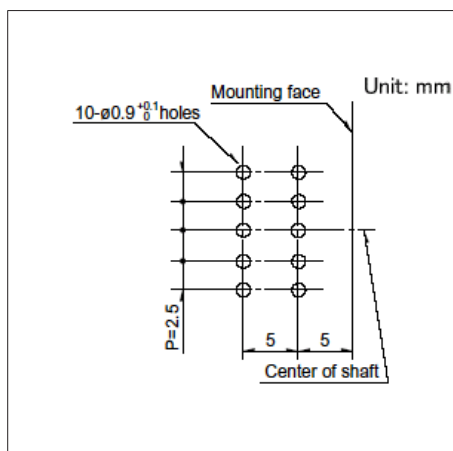

Viewed from direction A in the dimensions.

- Circuit Diagram

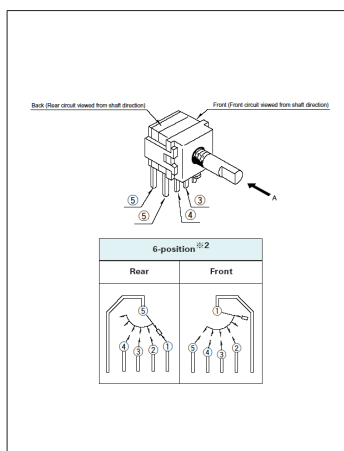

1. Viewed from direction A.
2. Circuit steps are 3 to 6 positions at front and 1 to 4 positions at rear.
3. It is necessary external wiring of common terminals.
4. For positions 6, 1 section consists of 1-pole.

6-positions Horizontal Type  
SRBM Series

## Drawing No.9

## ■ Dimensions

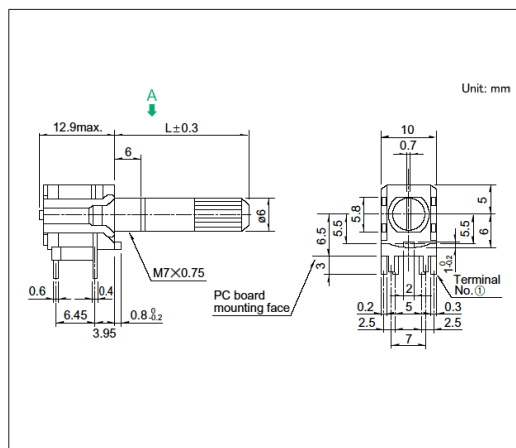

## ■ Mounting Hole Dimensions

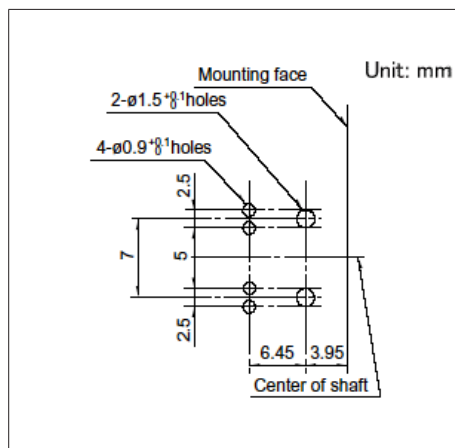

Viewed from direction A in the dimensions.

## ■ Circuit Diagram

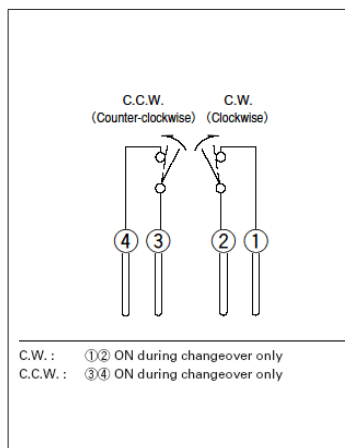

Pulse Switch

## Drawing No.10

## ■ Dimensions

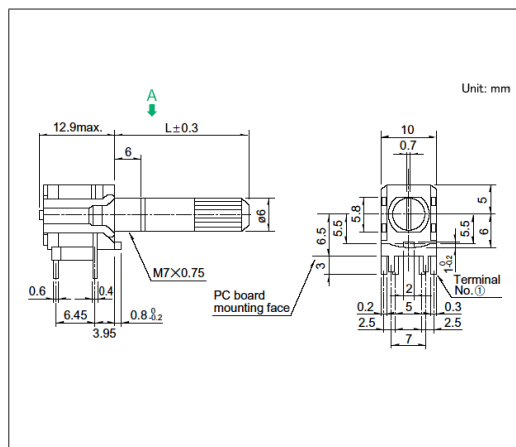

## ■ Mounting Hole Dimensions

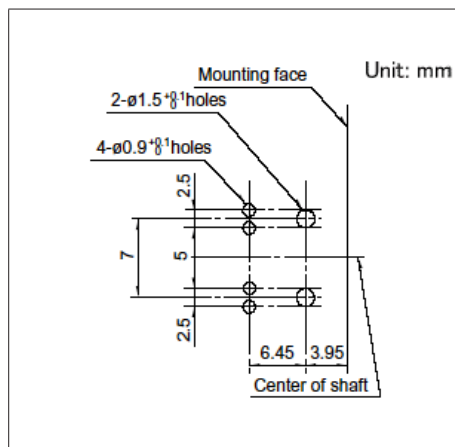

Viewed from direction A in the dimensions.

## ■ Circuit Diagram

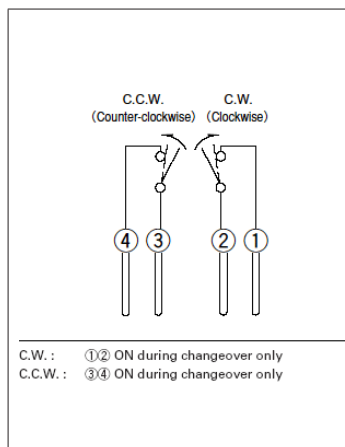

Pulse Switch