

Switches

Detector Switches

Compact Two-way, Two-step Detection

SSCQ Series

Two-stage detection type, 30% smaller than conventional products, among the smallest in the industry.



- Rating(max.)/(min.)(Resistive load): 1mA 5V DC/50 μ A 3V DC
- Contact resistance(Initial/After operating life): 2 Ω max./5 Ω max.
- Operating life without load: 50,000 cycles
- Operating life with load Rating(max.)(Resistive load):
50,000 cycles 5 Ω max.

Applications: Audio_TV: Cameras

■ Product List

Products No.	Poles	Positions	Operating force	Total travel position	Location lug	Dimensions (W×D×H) (mm)	Water-proof	Dust-proof	Automotive	Drawing No.
SSCQ110100	1	Two-direction, 2-positions each side	0.35N max.	3.73	With	3.8×3.6×0.9	—	—	—	1
SSCQ120102	1	Two-direction, 2-positions each side	0.35N max.	3.73	Without	3.8×3.6×0.9	—	—	—	2

⚠ Note

1. This catalog shows only outline specifications. When using the products, please obtain formal specifications for supply.
2. Please place purchase orders for taping products per minimum order unit (1 reel or a case).
3. For the Terminal Layout, please check our website.

■ Packing Specifications

Taping

Number of packages(pcs.)			Tape width (mm)	Export package measurements (mm)
1 reel	1 case / Japan	1 case / export packing		
4,000	8,000	16,000	16	417 x 409 x 139

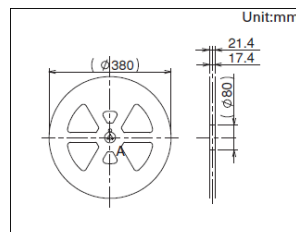

Drawing No.1

■ Dimensions

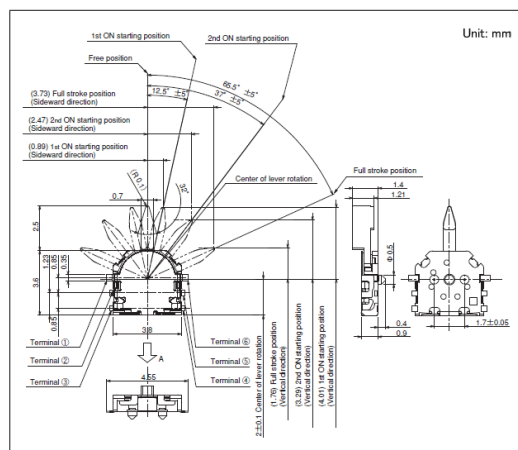

■ Land Dimensions

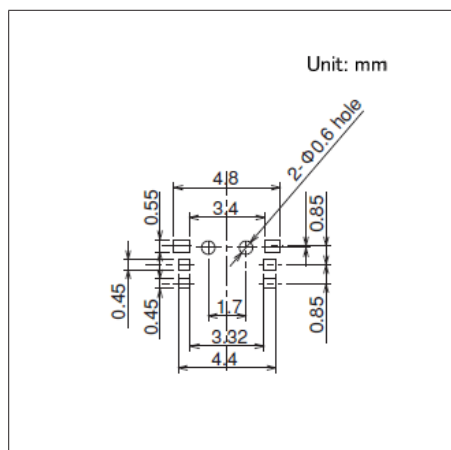

■ Circuit Diagram

